

HARBOUR BAY VILLAGE THE ADMIRAL

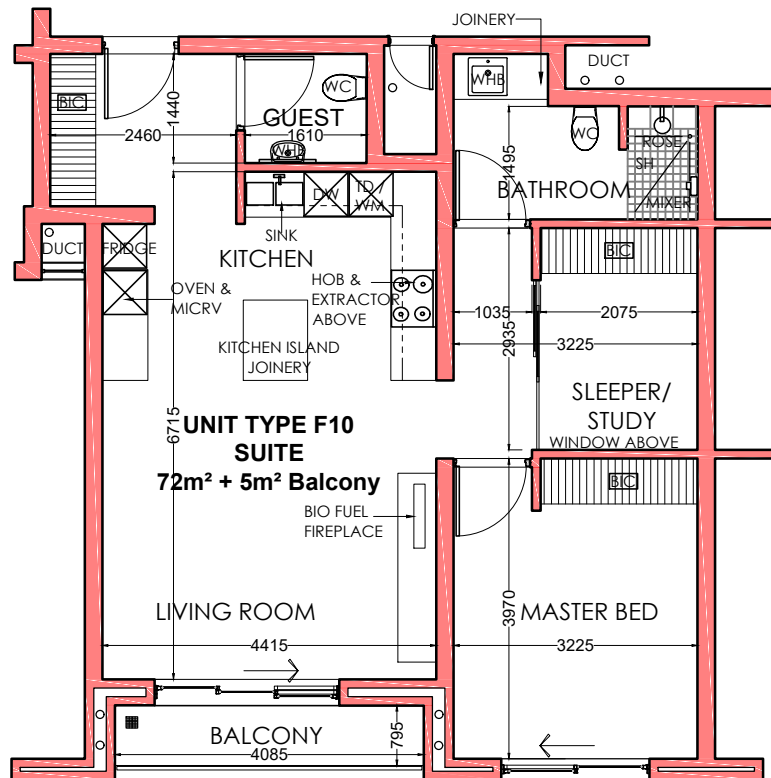

TYPICAL UNIT LAYOUT TYPE F10



UNIT TYPE F10 - TYPICAL DETAILS

Bedrooms: 1.5, Bathrooms: 1.5, Parking Bay: 1
Suite Size: 72m², Balcony: 5m², Total: 77m²